



Nintendo Switch

User guide

Table of Contents

1. Warnings & hazards.....	3
2. Fun awaits you on the Nintendo Switch!.....	5
3. What's in the box.....	6
4. Powering on & starting up.....	11
5. Powering off & sleep mode.....	12
6. Care & maintenance.....	12
7. Playing with friends.....	13
8. Troubleshooting.....	17



1. Warnings & hazards

Warnings warn you of incorrect use of the system that can result in injury. **Cautions** caution you about incorrect use that can result in damage to the system. →

1.1 Warning: Seizures

Anyone who has had a seizure, or who has an epileptic condition should consult a doctor prior to playing a video game.

Parents should watch their children play video games. Stop playing and consult a doctor if you or your child has any of the following symptoms:

- Convulsions
- Eye or muscle twitching
- Loss of awareness
- Altered vision
- Involuntary movements
- Disorientation

To reduce the likelihood of a seizure when playing video games:

- Sit or stand as far from the screen as possible.
- Play on the smallest available television screen.
- Do not play if you are tired or need sleep.
- Play in a well-lit place.
- Take a 10 to 15 minute break every hour.

1.2 Warning: Repetitive motion & eye strain

Playing video games can make your muscles, joints, skin, or eyes hurt. Follow these instructions to avoid problems such as tendinitis, carpal tunnel syndrome, skin irritation or eyestrain:

- Avoid excessive play. Parents should monitor their children for appropriate play.
- Take a 10 to 15 minute break every hour, even if you don't think you need it.

- If your hands, wrists, arms, or eyes become tired or sore while playing, or if you feel symptoms such as tingling, numbness, burning, or stiffness, stop and rest for several hours before playing again.
- If you continue to have any of the above symptoms or other discomfort during or after play, stop playing and see a doctor.

1.3 Caution: Motion Sickness

Playing video games can cause motion sickness in some players. If you or your child feels dizzy or nauseous when playing video games, stop playing and rest. Do not drive or engage in other demanding activity until you feel better.

1.4 Warning: Electric Shock

To avoid electric shock when you use this system:

- Disconnect the AC adapter during a lightning storm. There may be a risk of electric shock.
- To minimize the risk of damage to the system, only use Nintendo-licensed AC adapters.
- Do not use the AC adapter if it has damaged, split, or broken cords.
- Make sure that the AC adapter is fully inserted into the outlet.
- Always disconnect plugs by pulling on the plug and not the cord.

1.5 Warning: Battery Leakage

The Nintendo Switch and certain accessories contain a rechargeable lithium-ion battery. Leakage of ingredients contained within the battery can cause injury as well as damage to your Nintendo Switch system. If leakage occurs, avoid contact with skin. If contact occurs, immediately wash thoroughly with soap and water. If liquid leaking from a battery comes into contact with your eyes, immediately flush thoroughly with water and see a doctor.

To avoid battery leakage:

- Do not expose battery to excessive physical shock, vibration, or liquids.
- Do not disassemble, attempt to repair, or deform the battery.
- Do not dispose of battery in a fire.
- Do not touch the terminals of the battery or cause a short between the terminals with a metal object.

2. Fun awaits you on the Nintendo Switch!

This guide is everything you need to set up your Switch and make sure you're playing it the right way. Let's go! →

2.1 This guide is for you!

Use this guide if you have questions, concerns, or just want more information about your Nintendo Switch. It also contains important information on how to make sure you're using your Switch safely, and in a way that lets you have the most fun.

2.2 Two ways to play

Your Switch can be played in hand-held mode when you're on the go, and docked to your home TV for even bigger fun. Plus, the included Joy-Con controllers can be removed and used independently to support local multiplayer and motion controls.

2.3 Buy games online

The Nintendo e-shop has all the latest and best-selling games to download & purchase for your Switch. If your Switch runs out of memory, a memory card sold separately will give you more storage space. Visit the Nintendo online shop for more information.

2.4 Play with friends around the world

A Nintendo online membership will unlock online play for games that support it, let you save your games to the cloud, and more.

2.5 Still need help?

Talk to customer care at **(123) 456-7890** or visit nintendo.com/support

3. What's in the box

Your Nintendo Switch comes complete with everything you need to start playing right away. Keep reading for a summary of what's included. →

3.1 Your Nintendo Switch

The Nintendo Switch is a hand-held gaming console that can be connected to a TV via the included dock and HDMI output.

In hand-held mode, you can take your system with you and play when you're on the go. The Nintendo Switch plays games on a 6.2-inch capacitive LCD touch screen with a resolution of 1280 x 720 (up to 720p).

At the top left of the unit, you'll find the power button and volume controls. At the top right, you'll find a 3.5mm headphone jack and a cartridge slot for playing physical games.

At the bottom of the unit is a USB-C port for connecting your Switch to the included dock and for charging your Switch.

The back of your Switch features a stand which may be extended to prop the system on a hard, level surface. Under the stand is a microSD slot for expanding your system's storage capacity.

3.2 Left & Right Joy-Con Controllers

You can play games on your Switch with the Joy-Con controllers either attached or detached.

To attach the Joy-Cons, align the bottom of the Joy-Con with the top of the channel on the side of your Switch. Ensure that you are attaching the left Joy-Con to the left side, and the right Joy-Con to the right side. Slide the Joy-Con into place until you hear a click.



To detach the Joy-Cons, press and hold the black button found on the back of each Joy-Con and slide each Joy-Con up until it comes free from your Switch. The Joy-Cons can now be used independently, and each can serve as a standalone controller for multiplayer games.

Read the **Attachments & Accessories** section for more ways to use your Joy-Con controllers.

3.3 Cords & Cables

Your Switch includes a 120V power adapter with a standard wall plug for charging and docking your Switch, and an HDMI cable for connecting your dock to your TV.

3.4 The Dock

Use the dock to connect your Switch to your TV. When in docked mode, games play at a higher resolution (up to 1080p).

To connect the dock to your TV, find the door on the back of the dock which displays the Nintendo logo. It opens top-down to reveal USB-C, USB-A, and HDMI connections. Plug the included 120V power adapter into a wall outlet, and connect the other end to

the port labeled **AC ADAPTER**. Connect the included HDMI cable from the port labeled **HDMI OUT** to your TV's HDMI input. Your dock is now ready to use with your Nintendo Switch. The door will close with a click, and the gap on the left side will allow your cables to exit the unit.



To play your switch in docked mode, you'll need to detach the Joy-Con controllers, or consider purchasing a Nintendo Switch Pro Controller, sold separately. With the Joy-Cons detached, slide your Switch down into the dock.

Insert your Switch so that the USB-C port on the bottom of the unit connects with the USB-C connection at the bottom of your dock. The front of the dock is the same width as the screen on your Switch, so make sure you're keeping your Switch centered as you connect it. A green indicator light will flash at the bottom left of the dock when you have successfully docked your Switch.

3.5 Attachments & Accessories

Your Joy-Con controllers can be configured in multiple ways to support multiple ways of play.

When you're playing in docked mode, you can connect your Joy-Cons to the included controller attachment for a traditional console controller experience.

To attach the Joy-Cons to the controller attachment, simply slide each Joy-Con down into the corresponding channel of the controller attachment. Indicator lights will illuminate on the controller attachment when you're properly connected.



The Joy-Con controllers can also be connected to the included wrist-strap attachments, either when being used independently for multiplayer games, or for games that support motion controls.

Either wrist-strap attachment may be used on either Joy-Con, although care must be taken to ensure that you attach them properly.

To attach a wrist-strap to a Joy-Con, ensure that the wrist-strap attachment is oriented properly, with the nylon strap at the bottom. Align the bottom of the channel on the wrist-strap attachment with the top of the channel on the Joy-Con controller, and make sure that either the + or - icons on the Joy-Con correspond to the same icon on the wrist-strap attachment.



Once in place, lock the attachment with the labeled **LOCK** switch. Insert your hand through the nylon strap and adjust the strap to an appropriate tightness. This will prevent accidental injury or damage to your system when playing games with motion controls.



3.6 Ready to Play?

Now that you know all the different ways to play on your Switch, let's move to powering your system on and setting things up for the first time.

4. Powering on & starting up

Now that everything is properly connected, it's time to power on your Switch and perform the initial start-up process. →

4.1 Turning your Switch on

Press the power button located on the top left of your Switch. This method applies to both hand-held and docked mode.

4.2 Initial Start-Up

When you turn your Switch on for the first time, you'll go through the initial start-up process, which includes:

- Selecting your language & region
- Setting up an internet connection (optional)
- Setting your user icon & nickname
- Parental controls (optional)

5. Powering off & sleep mode

When you're all done playing, you can either put your Switch in sleep mode or power it off. →

5.1 Sleep Mode

From the home screen, select the  icon. You can also hold the home button and select **Sleep Mode** from the menu.

5.2 Powering Off

If you want to power off your Switch, hold the power button until the menu appears. Select **Power Options** and **Turn Off**. You might want to do this if you won't be able to charge your Switch for a while.

6. Care & maintenance

Follow these steps to keep your Switch in good working condition. →

6.1 Storage

Do not store your Switch in a high-humidity environment, on the floor, or in a place where it may attract moisture, dirt, dust, or foreign material.

6.2 While in use

Be gentle with your Switch. Do not throw, hit, or drop the console, as parts may break. Do not play your Switch in extreme cold or heat. Avoid exposing the screen to direct sunlight for an extended period.

6.3 Cleaning

If your screen gets dirty, wipe it off with a soft, clean cloth. Do not use harsh chemicals or liquid cleaning solutions to clean your Switch, as these may damage the system.

7. Playing with friends

If you have a friend who owns a Nintendo Switch, you can connect with them and add them as a friend. →

7.1 Your friends list

When you have somebody in your friends list, you can:

- Play together locally
- Play together remotely via an internet connection and a Nintendo Switch Online account
- See what games they're playing and share your play history with them

To add friends, the user profile on your Switch needs to be linked to a Nintendo account. There are a few ways to add somebody as a friend.

To Add a Friend

First, on the home page, select your user's icon.

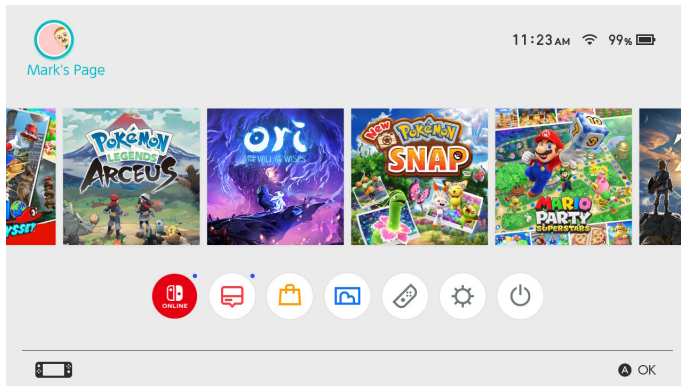

Scroll down to **Add Friend**. You'll see a few options:

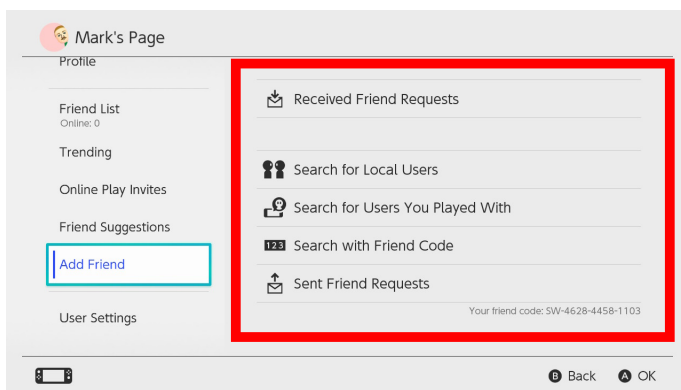

7.2 Received Friend Requests

This is where you can view the users who have added you as a friend, and either accept or delete their request.

7.3 Search for Local Users

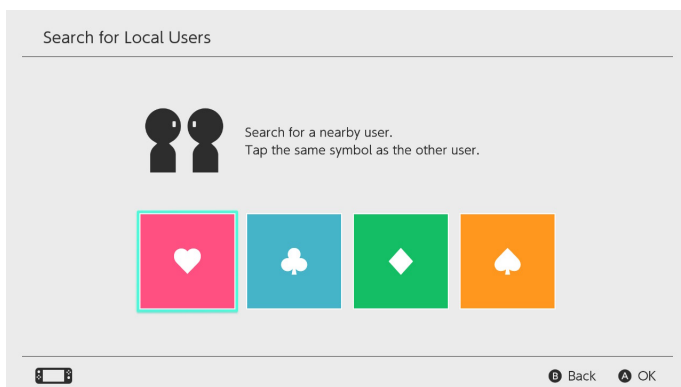

If you are near the person who you want to add, both users should go to this screen, and tap the same symbol on both of your systems.

7.4 Search for Users You Played With

This screen shows you a list of users you have played with. Select the user to send them a friend request.

7.5 Search with Friend Code

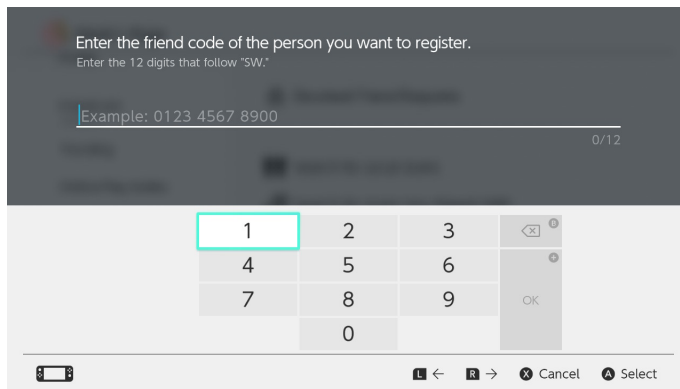

This will let you add a user by entering their friend code.

To find your friend code, select **Profile** under your user page.

7.6 Sent Friend Requests

This is a list of friend requests you have sent to other users.

7.7 Managing Your Friends List

Under **Friends List** on your user profile, you can view your friends, see what they've been playing, and perform actions to modify their friend status.

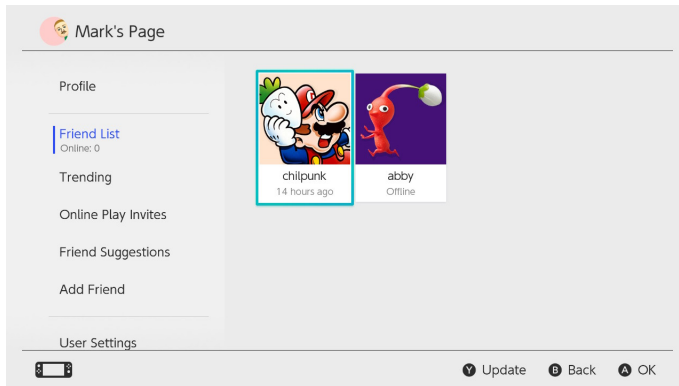

7.8 Your Friend's Profile

Here you'll see your friend's play activity, as well as the method and date of you becoming friends.

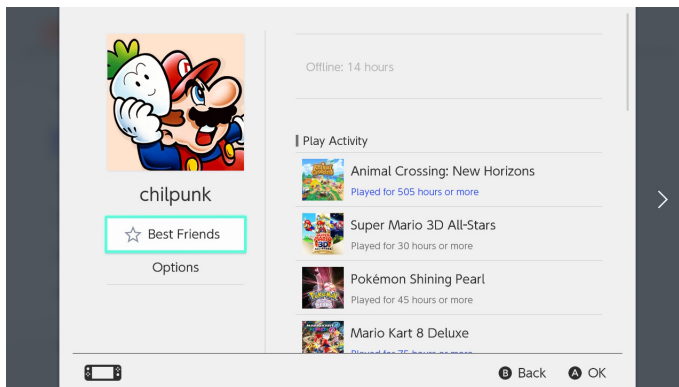

7.9 Options

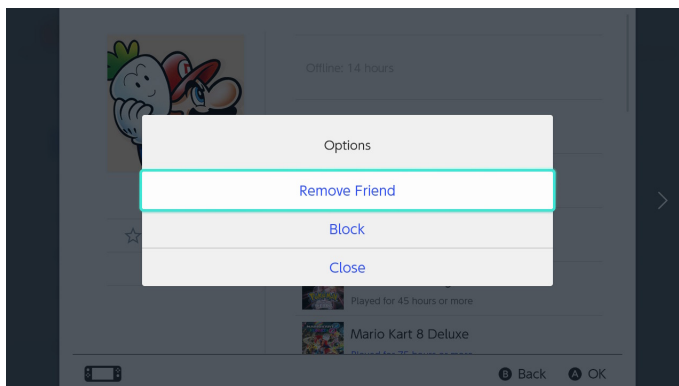

Remove Friend will remove this user from your friends list. They can still add you as a friend later.

Block will remove this user from your friends list and prevent them from viewing your profile or adding you as a friend.

8. Troubleshooting

These are some common issues you might run into when installing or playing your Switch. →

8.1 My Switch won't turn on or has a blank screen

Make sure your Switch is charged. Unplug the AC adapter from both ends and plug it back in.

Perform a hard reset by holding the power button for 20 seconds. After 20 seconds, press the power button again to turn the system on.



8.2 My Switch won't charge

Unplug the AC adapter from both ends and wait 30 seconds. Check the adapter for damage, including frayed cords or damaged connections. Replacement adapters may be purchased from the Nintendo online shop.

If there is no damage, connect the AC adapter directly to the Switch as shown.



8.3 My Joy-Cons aren't responding

Unplug the AC adapter from both ends and wait 30 seconds. Check the adapter for damage, including frayed cords or damaged connections. Replacement adapters may be purchased from the Nintendo online shop.

Reset the Joy-Cons by detaching them and pressing the SYNC button once on each controller.



8.4 My Switch won't dock to my TV

Unplug the AC adapter from both ends and wait 30 seconds. Check the adapter for damage, including frayed cords or damaged connections. Replacement adapters may be purchased from the Nintendo online shop.

Inspect your dock for any damage, including damaged ports or connections. If damaged, these parts will need to be replaced.

Connect your Switch directly to a wall outlet. Press the power button on the console if the screen does not turn on.



Works Cited

Process and procedure information as well as console images obtained from the Nintendo support website. UI images are original.

Warnings and hazards section retrieved from Nintendo.com consumer safety information.

<https://www.nintendo.com/sg/support/switch/friends/index.html>

<https://en-americas-support.nintendo.com>

https://www.nintendo.com/consumer/info/en_na/safety-information.jsp